



Thank you for purchasing the Heated glove switch. Before installing, please read the instruction carefully and keep it for future reference.

## ⚠ ATTENTION!

1. For installation, please follow the steps described in manual. Any damage caused by wrong installation shall be imputed to the users.
2. Do not disassemble or change any parts excluding the manual description.
3. The interior examination or maintenance should be executed by our professionals.

### MARK MEANING:

**NOTE** You could get the installation details from the information behind the mark.

⚠ Some processes must be followed to avoid the affection caused by wrong installation.

⚠ **WARNING!** Some processes must be followed to avoid damages to yourself or the public.

⚠ **CAUTION!** Some processes must be followed to avoid the damage to the vehicle.

📖 **READ CAREFULLY!** If any information dealt with in the manual remains unclear seek professional assistance.



Press the button one time

## 1 ACCESSORIES

<b>1</b> Heated Glove x2 	<b>2</b> M6 x 80L Screw x2 	<b>3</b> M6 X 80L Taper Screw x2 	<b>4</b> Fixed tube x2 	<b>5</b> Bushing x2 	<b>6</b> M6 flange nut x2 
<b>7</b> M6 x 12L Screw x2 	<b>8</b> Slide Fixed Rope x2 	<b>9</b> The heater switch x1 	<b>10</b> The connecting wire x1 	<b>11</b> The handle bar bracket x1 	<b>12</b> M3 x 12 L screw x2 
<b>13</b> M2 x 14 L screw x4 	<b>14</b> The Velcro x1 	<b>15</b> Rubber x1 (For 1 1/8") 			

**NOTE** Please contact the local distributor if the items you open are not the same, with the above-listed one.

## 2 Installation Instruction

**Fig 1**

● Installation Step 1: Please follow the Fig 1 to install accessories.

⚠ Before Installation, please check whether is Grip End installed on the side of the grip. If it does, please uninstall first then check the inner diameter of the grip is between 17-21mm. In case the inner diameter of the grip is not between 17-21mm then please refer to Installation Step 2. If there is no Grip End installed, please take off the grip cover and check the inner diameter of the grip is between 17-21mm, if the inner diameter of the grip is not between 17-21mm then please refer to Installation Step 2.

1. While checked the inner diameter of the grip is between 17-21mm. First, please using tools to make a orifice about diameter of 20-22mm at the end of the grip cover.
2. M6 X 80L SCREW (Accessory 2)
3. M6 X 80L TAPER SCREW x2 (Accessory 3)
4. HEATED GLOVE (Accessory 1)
5. FIXED TUBE (Accessory 4)
6. BUSHING (Accessory 5)
7. M6 FLANGE NUT (Accessory 6)
8. Please follow the direction of the arrow in Fig 1 to tighten the M6 X 80L SCREW.

**Fig 2**

● Installation Step 2: Please follow the Fig 2 to install accessories.

1. M6 X 12L SCREW (Accessory 7)
2. M6 X 80L TAPER SCREW x2 (Accessory 3)
3. HEATED GLOVE (Accessory 1)
4. M6 FLANGE NUT (Accessory 6)
5. Please follow the direction of the arrow in Fig 2 to tighten the M6 X 12L SCREW (Accessory 7).
6. Please follow Fig 3, using slide fixed rope (Accessory 8) to bind the mirror together.

⚠ To remove, please reverse the installation steps. Be aware while uninstall, please spin M6 X 12L SCREW (Accessory 7) first to let BUSHING (Accessory 5) loose a little to prevent the M6 FLANGE NUT (Accessory 6) and M6 X 12L SCREW to be totally separated. Then take out the FIXED TUBE (Accessory 4).

**NOTE** If FIXED TUBE (Accessory 4), BUSHING (Accessory 5) and M6 FLANGE NUT (Accessory 6) fall into the grip by accident, using blower to blow it out from another end of the tube would be recommended.

⚠ **CAUTION!** This product is suitable for the environment under 20 degree Celsius!

⚠ **CAUTION!** While using this product please keep the safe distance with vehicles on both side.

⚠ **CAUTION!** The power must be shut off when it's not riding.

### 3-1 Wiring installation instructions

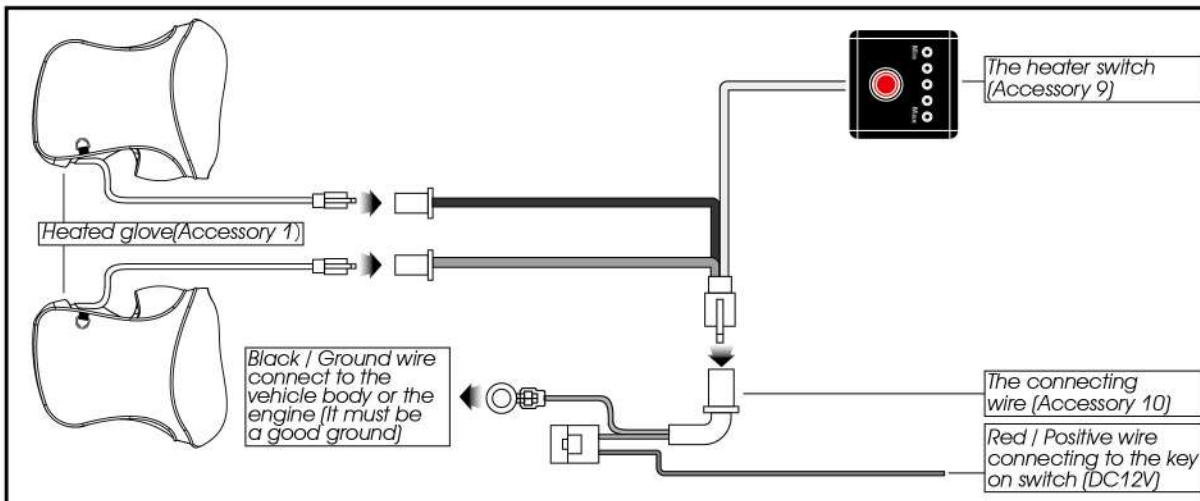

### 3-2 Installation instructions

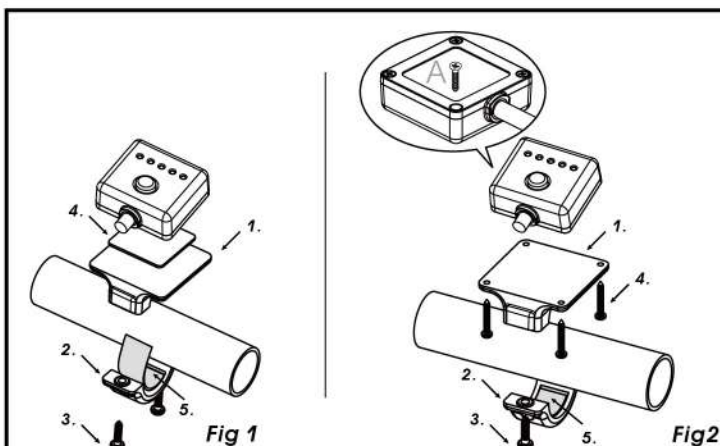

**When installing, please follow the process.**

1. The handle bar bracket (Accessory 11)
2. The handle bar bracket (Accessory 11)
3. The M3 x 12 L screw x 2 (Accessory 12)
4. The Velcro (Accessory 14)
5. The Rubber (Accessory 15)

**A** Please fix the handle bar bracket on the handle in advance and then stick the Velcro on the bracket. After it, use the Velcro to stick the switch on the bracket.

**NOTE** If you do not like using Velcro. Please unscrew the 4 screw back side of the switch. Using M2 X 14L screw (Accessory 13) locking bracket with switch together through existing screw hole on switch. Then you can fix switch on handle bar.

### 4-1 The operation instruction

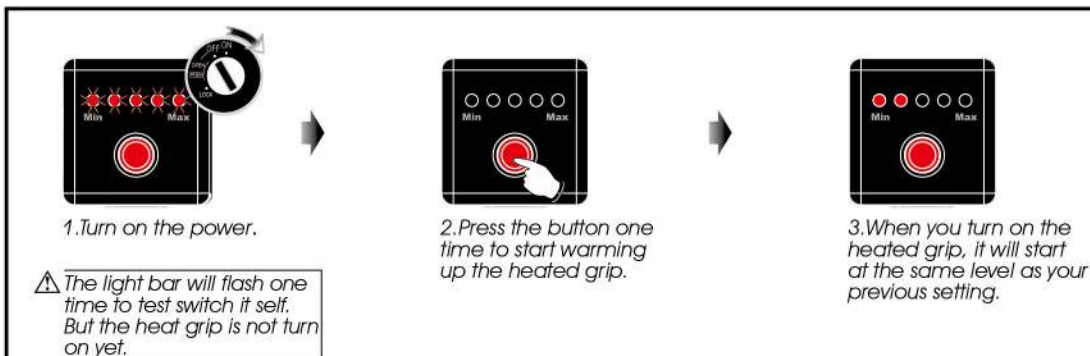

### 4-2 The Switch Setting Instruction

