



• Thank you for purchasing the KOSO heated grips. Before installing, read the instructions carefully and retain them for future reference.

Attention!

- For installation, follow the steps on the instruction sheet. Any damage caused by faulty installation shall be imputed to the users.
- Don't break or modify the wires.** To avoid a short circuit, do not pull the wires out of the terminals during installing.
- Do not disassemble, alter or change any parts.
- Maintenance or repairs should be executed by our professionals.

◎ MARK MEANING:

⚠ Some procedures must be followed to avoid damages occurring to the instrument.

⚠ **WARNING!** Some procedures must be followed to avoid injuries to the user or others.

⚠ **CAUTION!** Some procedures must be followed to avoid damages to the vehicle.

📖 **READ CAREFULLY!** If any information in the manual remains unclear, seek professional assistance.



FLASH



LIGHT ON



PRESS THE
BUTTON
ONCE



PRESS THE
BUTTON 3
SECONDS

1 Accessories

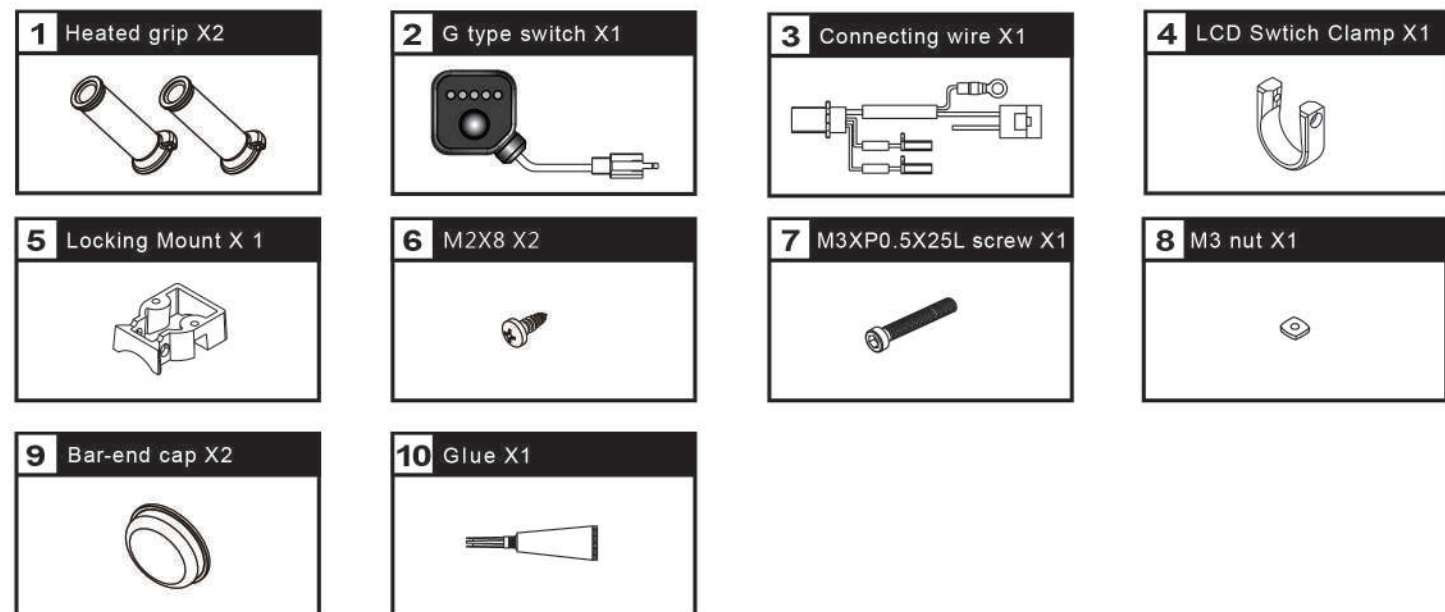

NOTE Contact your local distributor if the items received in the box are not the same as the one listed above.

2-1 Specifications

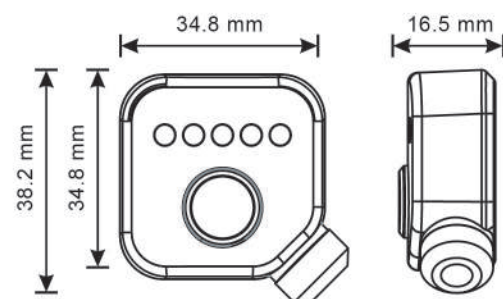

- Heating stage 1st stage (low) ~ 5th stage (high)
- Fuse type 4A (ASP)
- Effective temperature range JIS D 0203
- Voltage DC 12 V
- Switch size W38.2 X L38.2 X H16.5 mm
- Switch weight (with wire) About 88 g

NOTE Design and specifications are subject to change without notice!

2-2 Heated grip testing data

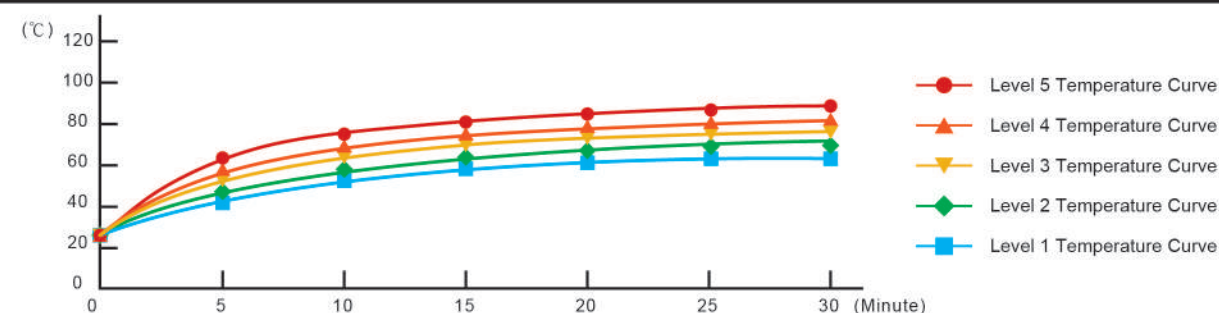

NOTE The testing environment is under 26 Degrees Celsius, with working voltage of 13.5 V.

3-1 Practical installation instruction

Heated grips installation procedure

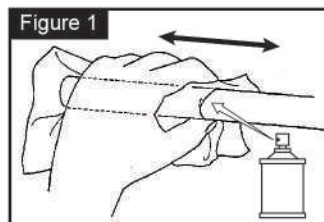

1. Use an appropriate tool to remove the original handlebar grips.
2. Apply a cleaning agent and wipe back and forth to remove the glue residue from the handlebar.

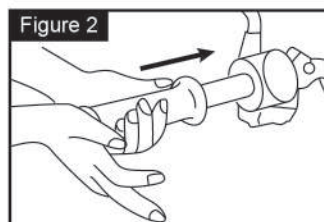

3. Push the heated grip straight onto the handlebar.

NOTE If the heating grip and the handlebar are loose; then apply the super glue (Accessory 9) to strengthen the hold to ensure that there will be no twisting during riding.

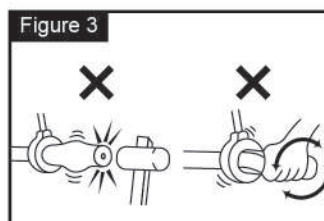

CAUTION! To install, do not use any tool to knock the grip on. Do not twist the grip by hand or with a tool. By doing so, this will break or damage the wire inside the handlebar.

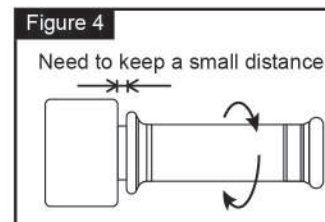

CAUTION! To install the heating grip onto the throttle sleeve, the throttle must maintain a small distance with a surplus distance for wiring; You must test them by rotating back and forth to make sure they can twist.

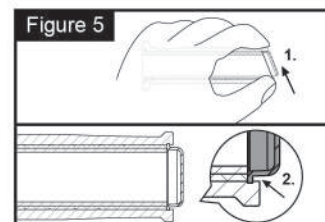

4. To install the side cap onto the heating grip, insert the top cap into the top groove and then press it downward into the bottom groove.

3-2 Control box installation instructions

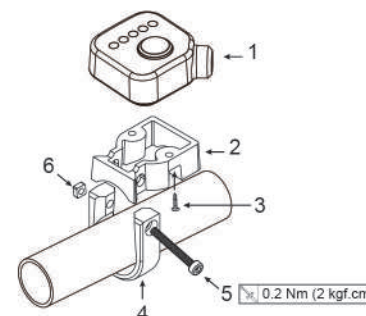

Installation steps

1. G switch (Accessory 2)
2. Locking Mount (Accessory 5)
3. M2X8 (Accessory 6)
4. LCD Switch Clamp (Accessory 4)
5. M3XP0.5X25L screw (Accessory 7) $\approx 0.2 \text{ Nm (2 kgf.cm)}$
6. M3 nut (Accessory 8)

3-3 Wiring installation instructions

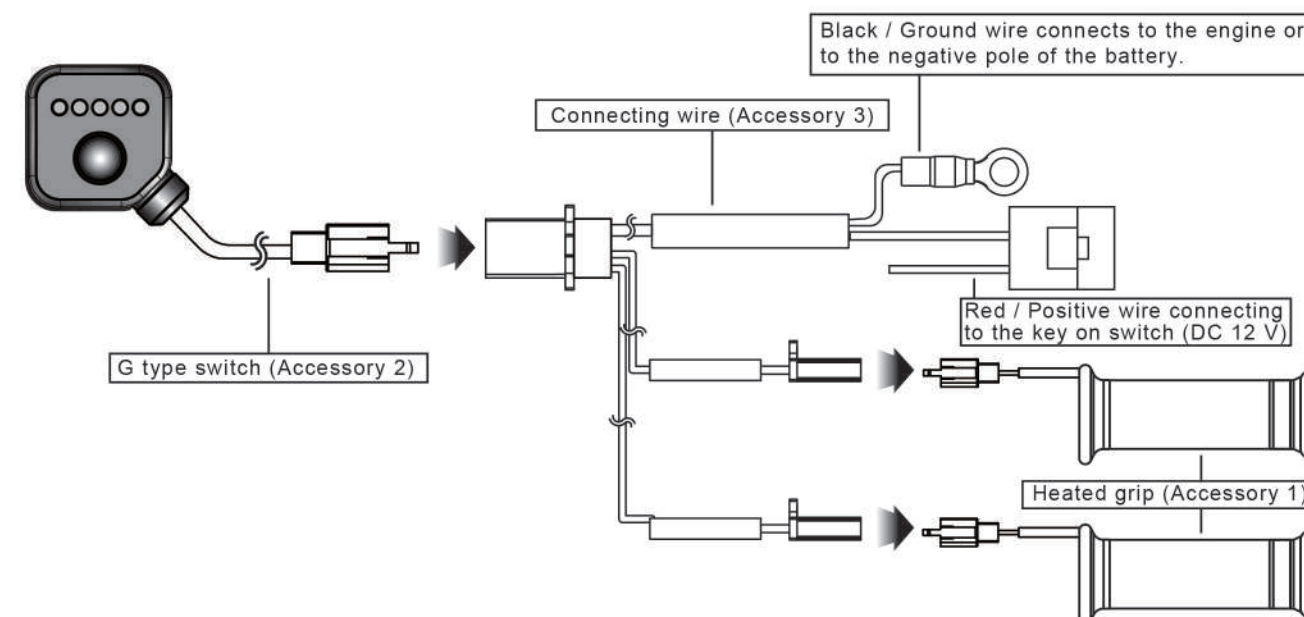

4-1 Specifications

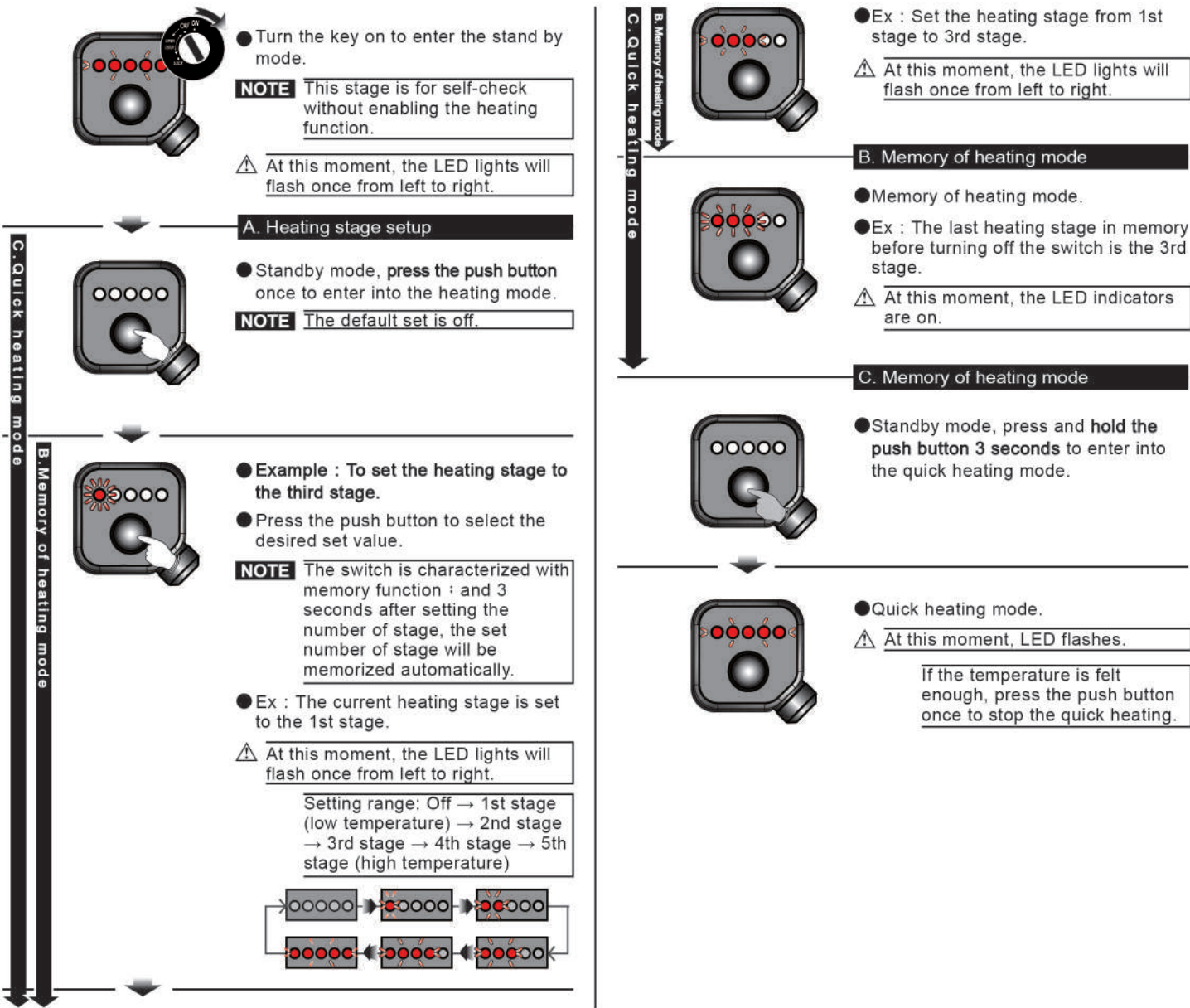

4-2 Low-voltage mode Description

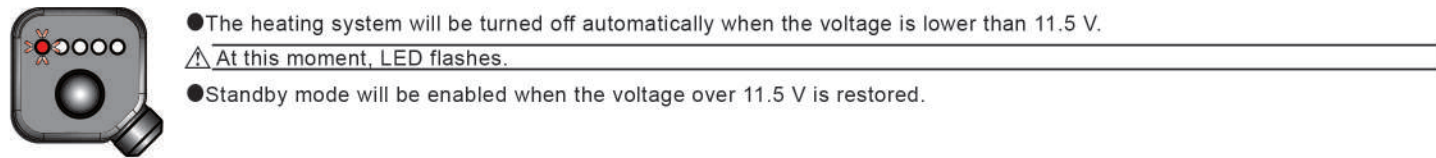

5 Trouble shooting

The following situation do not indicate malfunction of the meter. Pleasecheck the following before taking it in for repair.

Trouble	Check item	Trouble	Check item
LED indication does not activate.	<ul style="list-style-type: none">● Power supply cable disconnected. → Please check if power supply cable is broken or disconnected.● It might causing by the setting is not proper set up. → Please make sure and double check if setting is under the idle mode.	When turn the key on, the headed grip is not heating up.	<ul style="list-style-type: none">● It might be the battery is running out. → Please check your battery voltage as soon as possible.● It might be causing by no power supply. → Please check if power harness and fuse broken or disconnected.→ Please check if positive pole and negative pole is well connected.● It might be causing by improper setup. → Please check if all function setup is properly proceeded. Please referring to 4-1 Specification and check with each step.

※ If still can't solve the problems according to the step above, please contact with distributors or us.